

CERTIFICATE OF LOCATION OF GOVERNMENT CORNER

NORTH QUARTER Corner of Section 20, Township 114 N, Range 46 W
5th Principal Meridian, State of Minnesota, County of Yellow Medicine.

At the corner location shown on the sketch:

On 11/02/17 found a 1/2" rebar.
DATE

left monument as found lowered monument removed monument (explain)

On _____ placed a _____
DATE

SKETCH OF REFERENCE TIES

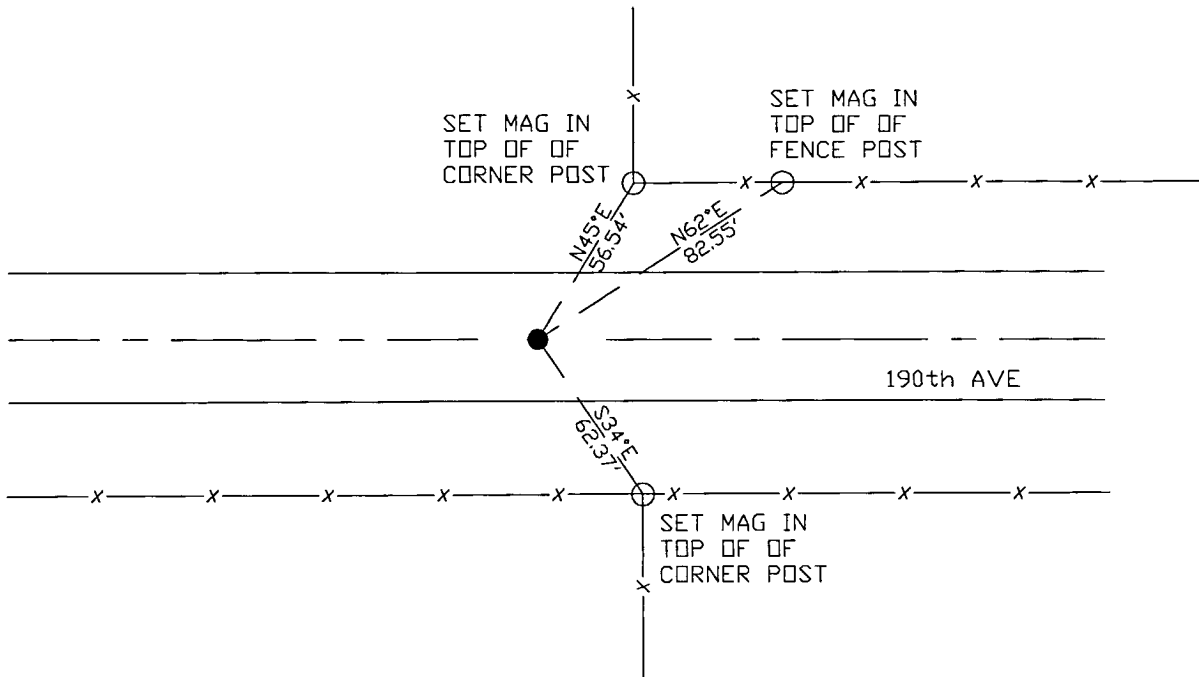

N.T.S.

Statement of evidence for this corner location is on back of this page.

I hereby certify that this document was researched and prepared by me or under my direct supervision and that I am a licensed Land Surveyor under the laws of the State of Minnesota.

Signature [Handwritten Signature]

Date 3/26/18 License No. 45874

Title:

- Land Surveyor Professional Engineer
- County Surveyor County Engineer

Doc# 268191 Fee: \$0.00 2 Pages

Property & Public Services
Property Records Division
Yellow Medicine County, Minnesota
I hereby certify that the within instrument was filed on April 5, 2018 at 10:55 AM

Janel Timm, Yellow Medicine County Recorder

By [Handwritten Signature] Deputy

STATEMENT OF EVIDENCE:

NORTH QUARTER OF SECTION 20, T114N, R46W, 5TH PM

1871 Corner was originally established by the U.S. General Land Office as a post set in raised mound.

2008 Roy Marihart completed a survey for Sections 19+20 in which he found a monument at the N1/4 corner Section 20, also found second monument 34.66' east.

2017-11-02 Westwood PS searched the area and found a 1/2" rebar that fits with Roy Marihart's 2008 survey for sections 19 and 20. Also found a 1/2" open pipe 34.68' east of the found rebar. Accepting the rebar as the corner location and set 3 reference ties.