

# CERTIFICATE OF LOCATION OF GOVERNMENT CORNER

EAST QUARTER Corner of Section 25, Township 114 N, Range 46 W  
 5th Principal Meridian, State of Minnesota, County of Yellow Medicine.

At the corner location shown on the sketch:

On \_\_\_\_\_ found a \_\_\_\_\_  
DATE

left monument as found       lowered monument       removed monument (explain)

On 12/07/17 placed a 1/2" rebar with cap RLS45874.  
DATE

SKETCH OF REFERENCE TIES

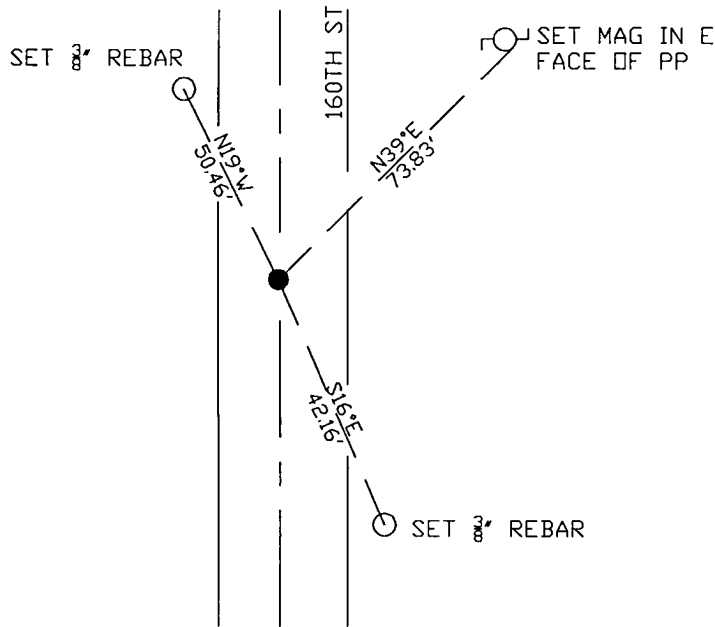

N.T.S.

Statement of evidence for this corner location is on back of this page.

I hereby certify that this document was researched and prepared by me or under my direct supervision and that I am a licensed Land Surveyor under the laws of the State of Minnesota.

Signature *[Handwritten Signature]*  
 Date 3/26/18 License No. 45874

Title:

- Land Surveyor       Professional Engineer  
 County Surveyor       County Engineer

**Doc# 268214 Fee: \$0.00 2 Pages**

Property & Public Services  
 Property Records Division  
 Yellow Medicine County, Minnesota  
 I hereby certify that the within instrument was filed on April 5, 2018 at 1:15 PM

Janel Timm, Yellow Medicine County Recorder

By *[Handwritten Signature]* Deputy

STATEMENT OF EVIDENCE:

EAST QUARTER OF SECTION 25, T114N, R46W, 5TH PM

*1858 Corner was originally established by the U.S. General Land Office as a post set in raised mound.*

*1902 Surveyors Record Book Page 522 shows corner located on line and equal distance between section corners, measuring 2641' to the NW and SW corners of Section 30.*

*Undated Resurvey in Record Book page 43 shows a distance of 5288' feet along east line of Section 25.*

*2017-12-07 Westwood PS searched the area and found nothing. Set 1/2" rebar with cap RLS45874 at equidistance and on centerline. Location fits e/w fence, accepting as corner location and set 3 reference ties.*