

CERTIFICATE OF LOCATION OF GOVERNMENT CORNER

 EAST QUARTER Corner of Section 20 , Township 114 N , Range 46 W
 5th Principal Meridian, State of Minnesota, County of Yellow Medicine.

At the corner location shown on the sketch:

On 10/25/17 found a 1/2" rebar.
DATE

left monument as found lowered monument removed monument (explain)

On placed a
DATE

SKETCH OF REFERENCE TIES

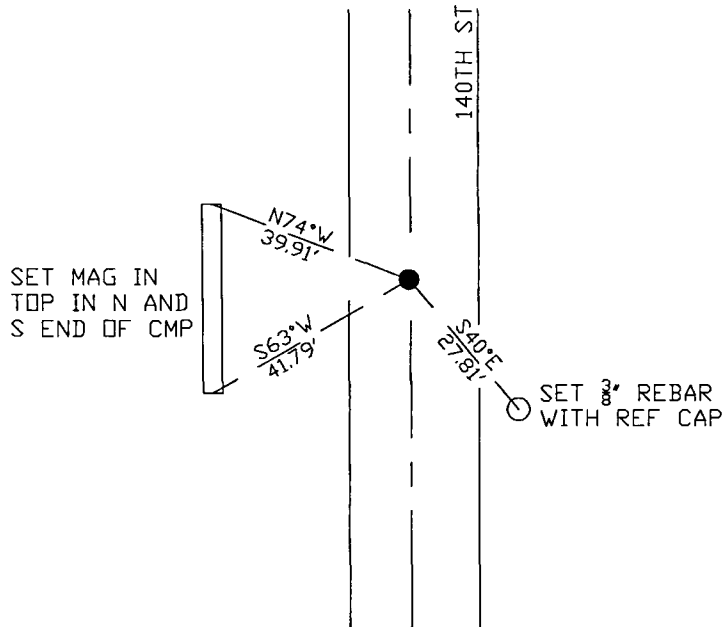

N.T.S.

Statement of evidence for this corner location is on back of this page.

I hereby certify that this document was researched and prepared by me or under my direct supervision and that I am a licensed Land Surveyor under the laws of the State of Minnesota.

Signature

Date 3/26/18 License No. 45874

Title:

- Land Surveyor Professional Engineer
 County Surveyor County Engineer

Doc# 268219 Fee: \$0.00 2 Pages

Property & Public Services
 Property Records Division
 Yellow Medicine County, Minnesota
 I hereby certify that the within instrument was filed on April 5, 2018 at 1:40 PM

Janel Timm, Yellow Medicine County Recorder

By Deputy

STATEMENT OF EVIDENCE:

EAST QUARTER OF SECTION 20, T114N, R46W, 5TH PM

1871 Corner was originally established by the U.S. General Land Office as a post set in raised mound.

1921 Surveyors Record Book page 447 survey completed in which W1/4 was located in line and equal distance between corners and set stone.

2008 Roy Marihart completed a survey for Sections 19+20 in which he found a monument at the W1/4 corner Section 20.

2017-10-25 Westwood PS searched the area and found 1/2" rebar, which fits the 2008 survey. Accepting monument as the corner location and set 3 reference ties.