

CERTIFICATE OF LOCATION OF GOVERNMENT CORNER

NORTHWEST Corner of Section 6, Township 114 N, Range 46 W
 5th Principal Meridian, State of Minnesota, County of Yellow Medicine.

At the corner location shown on the sketch:

- On _____ found a _____
DATE
- left monument as found lowered monument removed monument (explain)
- On 12/09/17 placed a 1/2" rebar RLS 45874 per highway stationing and distance from
DATE fence evidence at Quarter corner to the East.

SKETCH OF REFERENCE TIES

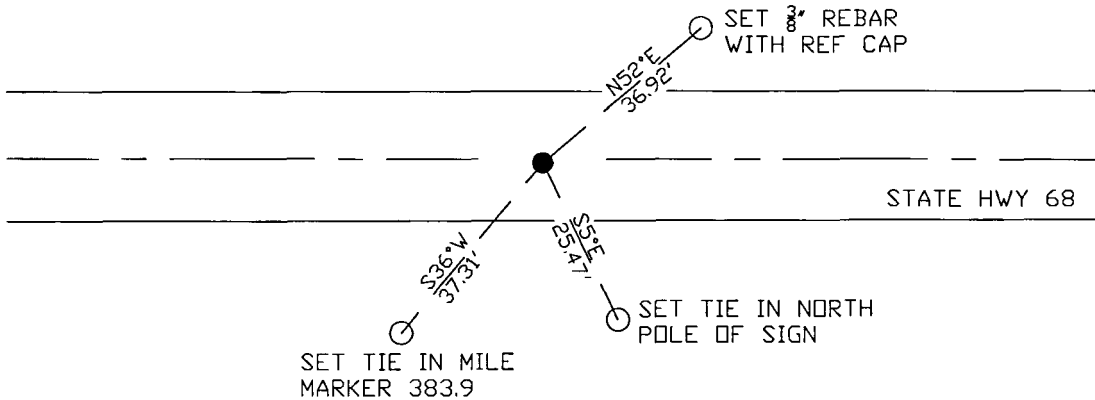

Statement of evidence for this corner location is on back of this page.

I hereby certify that this document was researched and prepared by me or under my direct supervision and that I am a licensed Land Surveyor under the laws of the State of Minnesota.

Signature *[Handwritten Signature]*
 Date 3/26/18 License No. 45874

Title:

- Land Surveyor Professional Engineer
 County Surveyor County Engineer

Doc# 268231 Fee: \$0.00 2 Pages
 Property & Public Services
 Property Records Division
 Yellow Medicine County, Minnesota
 I hereby certify that the within instrument was filed on April 5, 2018 at 2:40 PM

Janel Timm, Yellow Medicine County Recorder
 By *[Handwritten Signature]* Deputy

STATEMENT OF EVIDENCE:

NORTHWEST OF SECTION 6, T114N, R46W, 5TH PM

1871 Corner was originally established by the U.S. General Land Office as a post set in raised mound.

1901 Surveyors Record Book shows a set iron monument at this location.

1902 Re-Survey of State-Line shows a square iron monument in place at corner location.

1947 MNDT shows the corner location at intersection of road east and fence south. 51.0 feet from P.I. 100+52.1

2017-12-09 Westwood PS seached the area and found a mag nail. Mag nail does not fit highway stationing (12 feet west of highway plan stationing), do not accept mag nail as the corner location. Set 1/2" rebar RLS 45874 per highway stationing and distance from fence evidence at Quarter corner to the East, and set 3 reference ties.