

CERTIFICATE OF LOCATION OF GOVERNMENT CORNER

NORTH QUARTER Corner of Section 32, Township 114 N, Range 46 W

5th Principal Meridian, State of Minnesota, County of Yellow Medicine.

At the corner location shown on the sketch:

On _____ found a _____
DATE

left monument as found lowered monument removed monument (explain)

On 10/25/17 placed a 1/2" rebar with cap LS45874.
DATE

SKETCH OF REFERENCE TIES

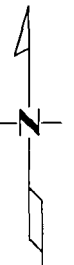
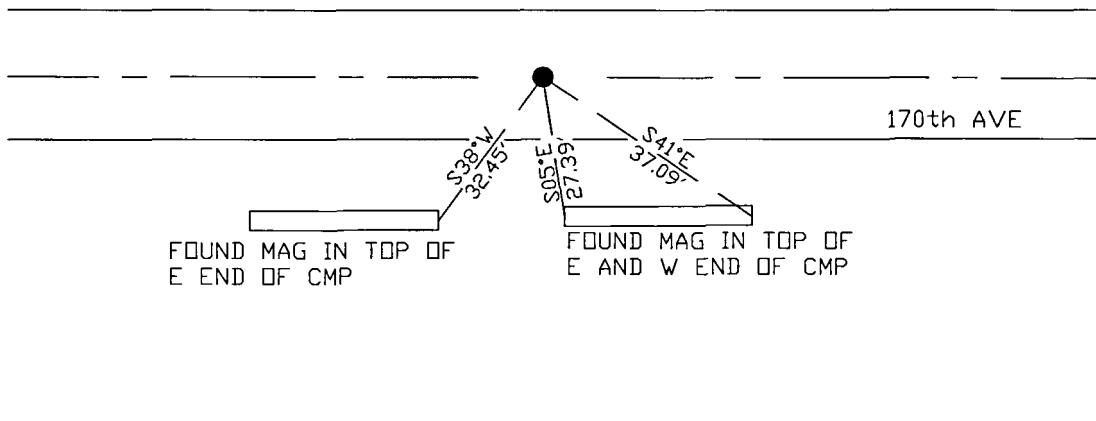

N.T.S.

Statement of evidence for this corner location is on back of this page.

I hereby certify that this document was researched and prepared by me or under my direct supervision and that I am a licensed Land Surveyor under the laws of the State of Minnesota.

Signature *[Handwritten Signature]*

Date 3/26/18 License No. 45874

Title:

- Land Surveyor Professional Engineer
 County Surveyor County Engineer

Doc# 268255 Fee: \$0.00 2 Pages

Property & Public Services
 Property Records Division
 Yellow Medicine County, Minnesota
 I hereby certify that the within instrument
 was filed on April 6, 2018 at 10:30 AM

Janel Timm, Yellow Medicine County Recorder

By *[Handwritten Signature]* Deputy

STATEMENT OF EVIDENCE:

NORTH QUARTER OF SECTION 32, T114N, R46W, 5TH PM

1871 Corner was originally established by the U.S. General Land Office as a post set in raised mound.

1910 John Norgaard, County Surveyor, Surveyors Record Book page 214 has survey completed for Section 32 in which Stone was set on line and equal distance between section corners.

1920 Surveyors Record Book page 436, found stone in place.

1978 Gary Stevenson completed a corner record dated 10/20/1978 in which a 3/4" iron rod was set over a found 15"x10"x8" stone.

2017-10-25 Westwood PS searched the area and found reference ties from the 1978 corner record by Gary Stevenson, LS 12684, but did not find the monument. Set 1/2" rebar with cap LS 45874 per found 1978 ties.