

CERTIFICATE OF LOCATION OF GOVERNMENT CORNER

 NORTH QUARTER Corner of Section 34 , Township 114 N , Range 46 W
 5th Principal Meridian, State of Minnesota, County of Yellow Medicine.

At the corner location shown on the sketch:

- On 10/25/17 found a DNR SURVEY MARKER Aluminum cap.
DATE
- left monument as found lowered monument removed monument (explain)
- On placed a
DATE

SKETCH OF REFERENCE TIES

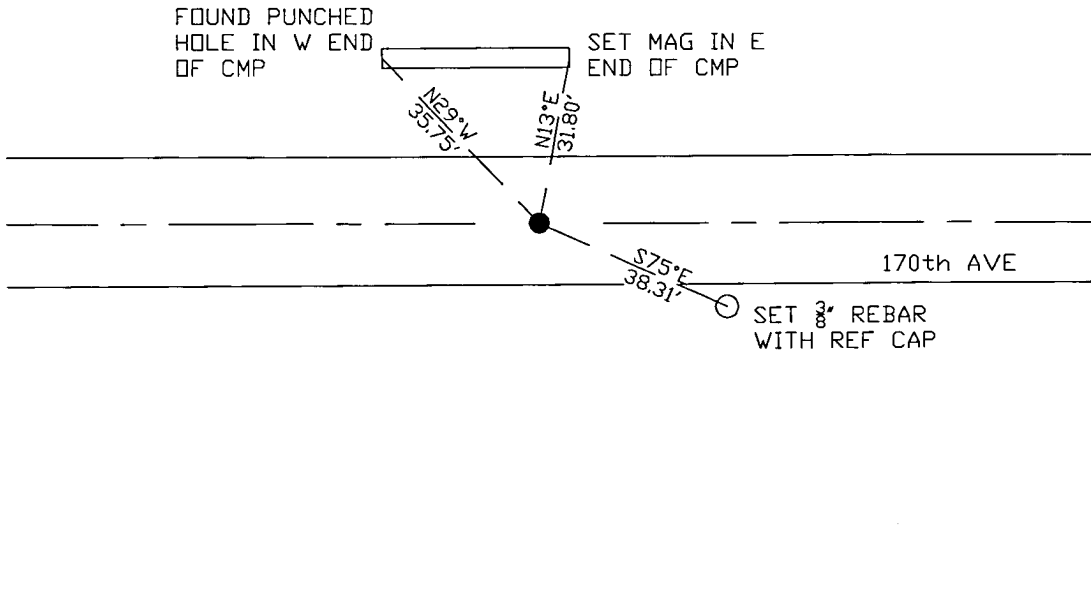

Statement of evidence for this corner location is on back of this page.

I hereby certify that this document was researched and prepared by me or under my direct supervision and that I am a licensed Land Surveyor under the laws of the State of Minnesota.

Signature
 Date 3/26/18 License No. 45874

Title:

- Land Surveyor Professional Engineer
- County Surveyor County Engineer

Doc# 268257 Fee: \$0.00 2 Pages
 Property & Public Services
 Property Records Division
 Yellow Medicine County, Minnesota
 I hereby certify that the within instrument was filed on April 6, 2018 at 10:40 AM

Janel Timm, Yellow Medicine County Recorder

By Kelly Kauger Deputy

STATEMENT OF EVIDENCE:

NORTH QUARTER OF SECTION 34, T114N, R46W, 5TH PM

1871 Corner was originally established by the U.S. General Land Office as a post set in raised mound.

1909 John Norgaard, County Surveyor, completed a survey in Section 34, Surveyors Record Book page 198, in which he located on line and equal distances between Section Corners.

2001 MN DNR completed a survey for Sections 33 and 34 in which they set a DNR SURVEY MARKER over a found stone monument at the corner location, and filed a corner record dated 06/04/01.

N: 138248.039

E: 372750.641

2017-10-25 Westwood PS searched the area and found a DNR SURVEY MARKER Aluminum cap and 1 reference tie which agrees with 2001 DNR corner record. Accepting monument as the corner location and set 2 additional reference ties.