

CERTIFICATE OF LOCATION OF GOVERNMENT CORNER

 NORTHEAST Corner of Section 3 , Township 114 N , Range 46 W
 5th Principal Meridian, State of Minnesota, County of Yellow Medicine.

At the corner location shown on the sketch:

On 10/27/17 found a 6X6 planted stone
DATE

left monument as found lowered monument removed monument (explain)

On placed a
DATE

SKETCH OF REFERENCE TIES

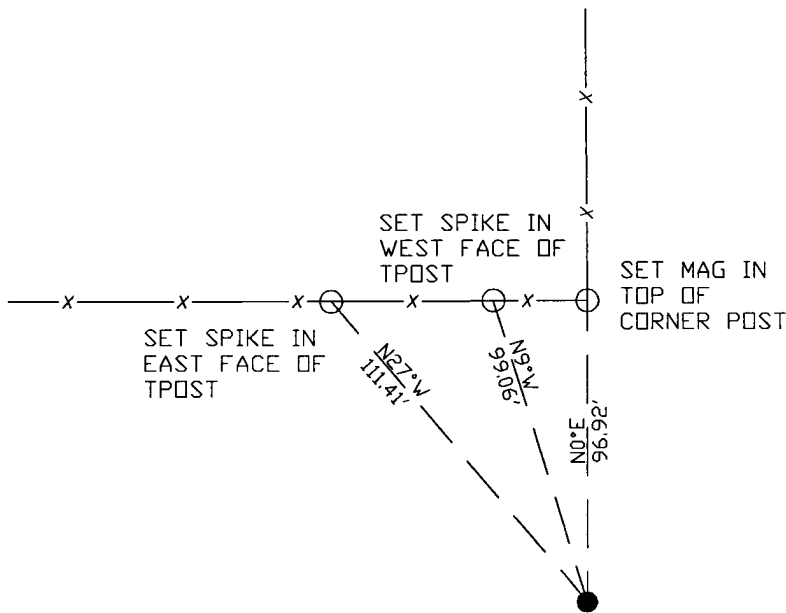

Statement of evidence for this corner location is on back of this page.

I hereby certify that this document was researched and prepared by me or under my direct supervision and that I am a licensed Land Surveyor under the laws of the State of Minnesota.

Signature *[Signature]*
 Date 3/26/18 License No. 45874

Title:

- Land Surveyor Professional Engineer
 County Surveyor County Engineer

Doc# 268259 Fee: \$0.00 2 Pages

Property & Public Services
 Property Records Division
 Yellow Medicine County, Minnesota
 I hereby certify that the within instrument was filed on April 6, 2018 at 10:50 AM

Janel Timm, Yellow Medicine County Recorder

By *[Signature]* Deputy

STATEMENT OF EVIDENCE:

NORTHEAST OF SECTION 3, T114N, R46W, 5TH PM

1871 Corner was originally established by the U.S. General Land Office as a post set in raised mound.

Undated Resurvey completed in which a Government stake and mound were found and set top of monument 4" above ground.

1935 MNDT Right of Way Map shows a 6"x6" stone in place and 686.6 feet south of centerline.

2016 Roy Marihart completed a survey in section 34 in which he found a monument in place at the corner location.

2017-10-27 Westwood PS searched the area and found a 6"x6" stone planted 4" above grade. Stone matches highway plans(6x6 granite 668.6 south of 21+09.9 -from tangent line, not curve), accepting stone as the corner location and set 3 reference ties.