

# CERTIFICATE OF LOCATION OF GOVERNMENT CORNER

NORTHEAST Corner of Section 21, Township 114 N, Range 46 W

5th Principal Meridian, State of Minnesota, County of Yellow Medicine.

At the corner location shown on the sketch:

On 10/27/17 found a 3/4" iron rod.  
DATE

left monument as found       lowered monument       removed monument (explain)

On \_\_\_\_\_ placed a \_\_\_\_\_  
DATE

### SKETCH OF REFERENCE TIES

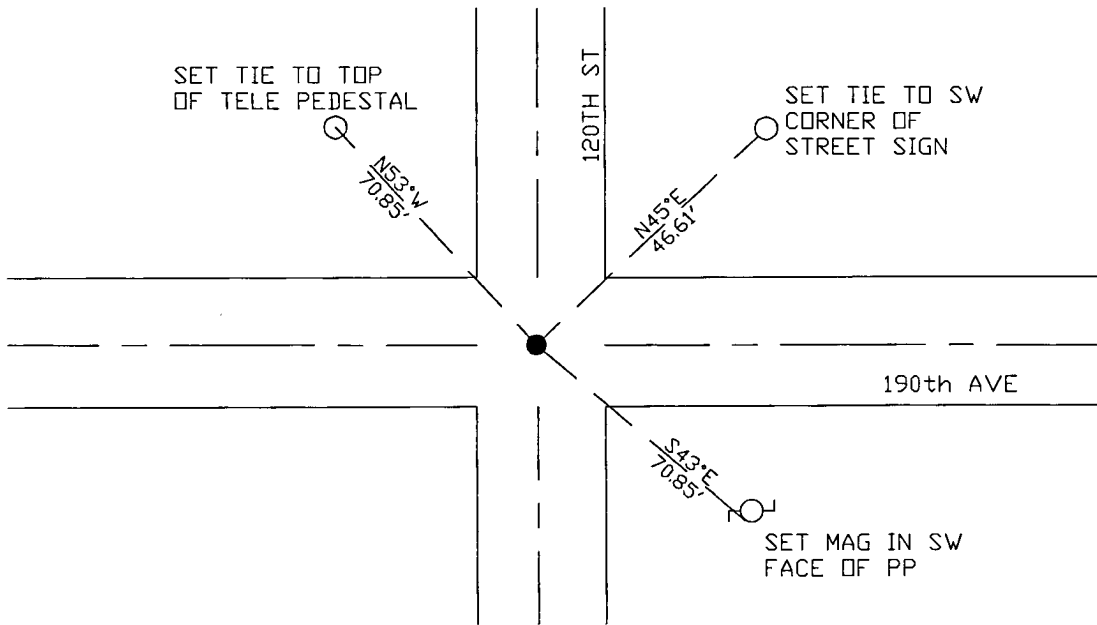

N.T.S.

Statement of evidence for this corner location is on back of this page.

I hereby certify that this document was researched and prepared by me or under my direct supervision and that I am a licensed Land Surveyor under the laws of the State of Minnesota.

Signature *Janel Timm*

Date 3/26/18 License No. 45874

Title:

- Land Surveyor       Professional Engineer  
 County Surveyor       County Engineer

**Doc# 268272 Fee: \$0.00 2 Pages**

Property & Public Services  
 Property Records Division  
 Yellow Medicine County, Minnesota  
 I hereby certify that the within instrument was filed on April 6, 2018 at 12:40 PM

Janel Timm, Yellow Medicine County Recorder

By *Kelly Kauger* Deputy

STATEMENT OF EVIDENCE:

NORTHEAST OF SECTION 21, T114N, R46W, 5TH PM

*1871 Corner was originally established by the U.S. General Land Office as a post set in raised mound.*

*Undated township resurvey – found stone in government mound*

*1921 – Survey of section 21 made by John Norgaard, county surveyor shows a distance of 2640.7' to the E1/4 corner.*

*2017–10–17 Westwood PS received coordinates for this corner location from the County Highway Department.*

*2017–10–27 Westwood PS searched the area and found a 3/4" iron rod which agrees with coordinates from the County Highway Department and measurement to E1/4 corner measures closely with the 1921 survey. Accepting as the corner location and set 3 reference ties.*