

CERTIFICATE OF LOCATION OF GOVERNMENT CORNER

NORTHEAST Corner of Section 31, Township 115, Range 43, 5TH P.M.

STATE OF MINNESOTA, County of YELLOW MEDICINE

At the corner location shown on the sketch:

- On _____ found a _____
DATE
- left monument as found, lowered monument, removed monument (explain)
- On Nov. 25, 2019 placed a 5/8' iron with seal no. 43844
DATE

SKETCH OF REFERENCE TIES

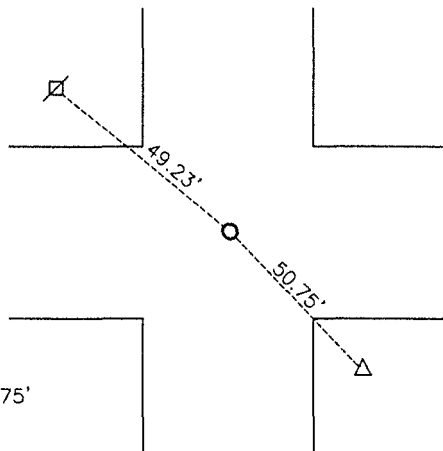

Nail and Seal in power pole NW 49.23'
Top center of telephone pedestal SE 50.75'

Yellow Medicine County
Coordinate System NAD83 (1996)

N: 169496.673
E: 455067.376

Statement of evidence relative to this corner location is on back of page.

I hereby certify that this document and the data contained herein was prepared by me or under my direct supervision.

Daniel L. Bueltel
License No. 43844

12/3/2019
DATE

Doc# 272033 Fee: \$0.00 2 Pages

Property & Public Services
Property Records Division
Yellow Medicine County, Minnesota
I hereby certify that the within instrument was filed on December 17, 2019 at 11:10 AM

Janel Timm, Yellow Medicine County Recorder

By Kelly Kauger Deputy

Statement of Evidence

NE 31-115-43

In 1911, John Norgaard set a stone.

August 2, 2006, Bueltel-Moseng Land Surveying dug with backhoe and found a stone and 18" wood stake. Set an iron wiht seal no. 11943 and a iron pipe next to stone. placed a 1" pipe with seal no. 11943 at road surface.

November 25, 2019, Bueltel-Moseng Land Surveying found nothing. Placed a 5/8" iron with seal no. 43844 at the corner using information from survey in 2006.